

Basic Pedestal Self Priming Centrifugal Pump



Models 81 1/2E3-B and 81 1/2E52-B

Size 1 1/2" x 1 1/2"

PUMP SPECIFICATIONS

Size: 1 1/2" x 1 1/2" (38,1 mm x 38,1 mm) NPT - Female.

Casing: Gray Iron 30.

Maximum Operating Pressure 47 psi (324 kPa).*

Semi-Open Type, Five Vane Impeller:

(81 1/2E3-B) Copper Alloy C93700.

(81 1/2E52-B) Gray Iron 30.

Handles 1/4" (6,4 mm) Diameter Spherical Solids.

Impeller Shaft: Carbon Steel 1215.

Replaceable Vane Plate: Gray Iron 30.

Bearing Housing: Gray Iron 30.

Intermediate Bracket: Gray Iron 30.

Radial/Thrust Bearings: Sealed Single Row Ball.

Bearing Lubrication: Self-Lubricated.

Hardware: Standard Plated Steel.

Optional Equipment: Strainer.

Consult Factory for Additional Options.

**Consult Factory for Applications Exceeding Maximum Pressure and/or Temperature Indicated.*

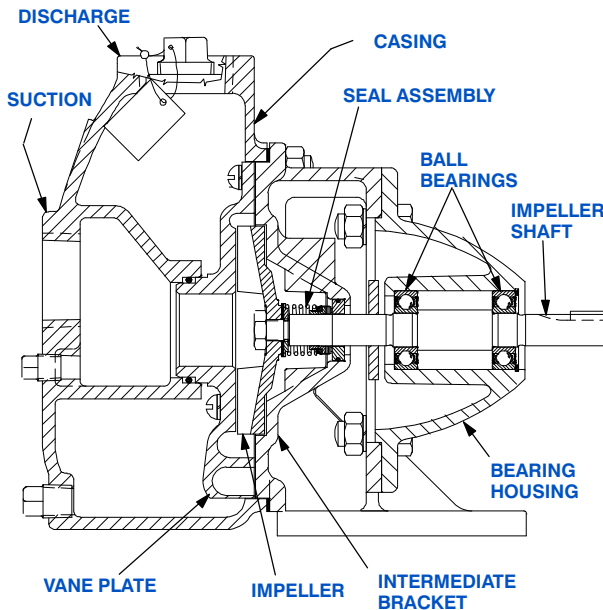

81 1/2E3-B SHOWN

81 1/2E3-B SEAL DETAIL

Type 21, Mechanical, Self Lubricated. Carbon Rotating Face and Ni-Resist Stationary Face. Stainless Steel 18-8 Cage and Spring. Fluorocarbon Elastomers (DuPont Viton® or Equivalent). Maximum Temperature of Liquid Pumped, 160°F (71°C).*

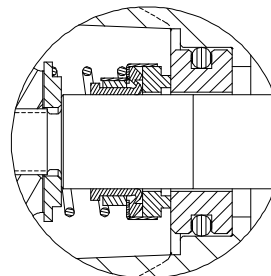
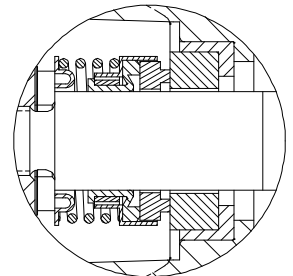

81 1/2E52-B SEAL DETAIL

Type 31, Mechanical, Self-Lubricated. Silicon Carbide Rotating and Stationary Faces. Fluorocarbon Elastomers (DuPont Viton® or Equivalent). Stainless Steel 304 Cage and Spring. Maximum Temperature of Liquid Pumped 160°F (71°C).*



GORMAN-RUPP PUMPS

www.grpumps.com

Specifications Subject to Change Without Notice

Printed in U.S.A.

PERFORMANCE
BASED ON
PETROLEUM

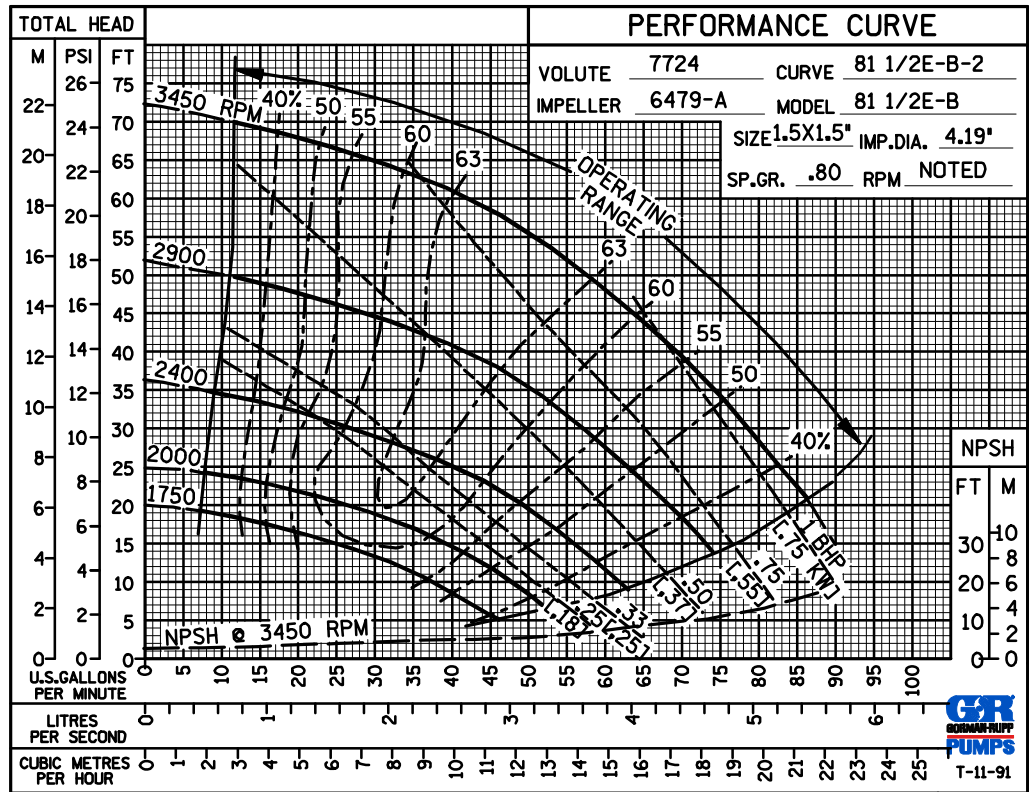

GORMAN-RUPP PUMPS

www.grpumps.com

Specifications Subject to Change Without Notice

Printed in U.S.A.