

Basic



Internal Gear Type Positive Displacement Pump



DESCRIPTION

Internal gear pumps are high quality units capable of 15 ft. (5 m.) of lift and smooth, consistent flow. This pump features a type 21 seal for pressures up to 200 psi (13,8 Bar) and flows up to 12 gpm (0.8 lps) with a maximum viscosity of 1500 SSU.

Cast iron gear pumps are reliable, cost-effective and low maintenance. For use with non-flammable liquids compatible with pump component materials.



PUMP SPECIFICATIONS

Basic Construction: Gray Iron.

Rotor and Idler: High Strength Iron.

Bushings: Carbon Graphite.

Idler Pin: Hardened Steel.

Seal: Type 21, Mechanical Self Lubricated. Carbon Rotating Face. Ceramic Stationary Face. Fluorocarbon Elastomers (DuPont Viton or Equivalent).

Maximum Temperature of Liquid Pumped 300°F (149°C).

Gaskets: Synthetic Fiber w/Nitrile Binder.

O-Rings: Fluorocarbon (DuPont Viton or Equivalent).

Pressure Relief Valve: Ductile Iron.
Pressure Setting: 75 PSI (5 BAR).



SPECIFICATIONS			
Model	Ship Wt. (Approx.)	SuctxDisch. (NPT)	Driver
GMC1DE3/40C	26 lbs. 11,8 kg.	1" x 1"	User Supplied.



GORMAN-RUPP PUMPS

www.grpumps.com

Specifications Subject to Change Without Notice

Printed in U.S.A.

Specification Data

SECTION 520, PAGE 20

APPROXIMATE DIMENSIONS

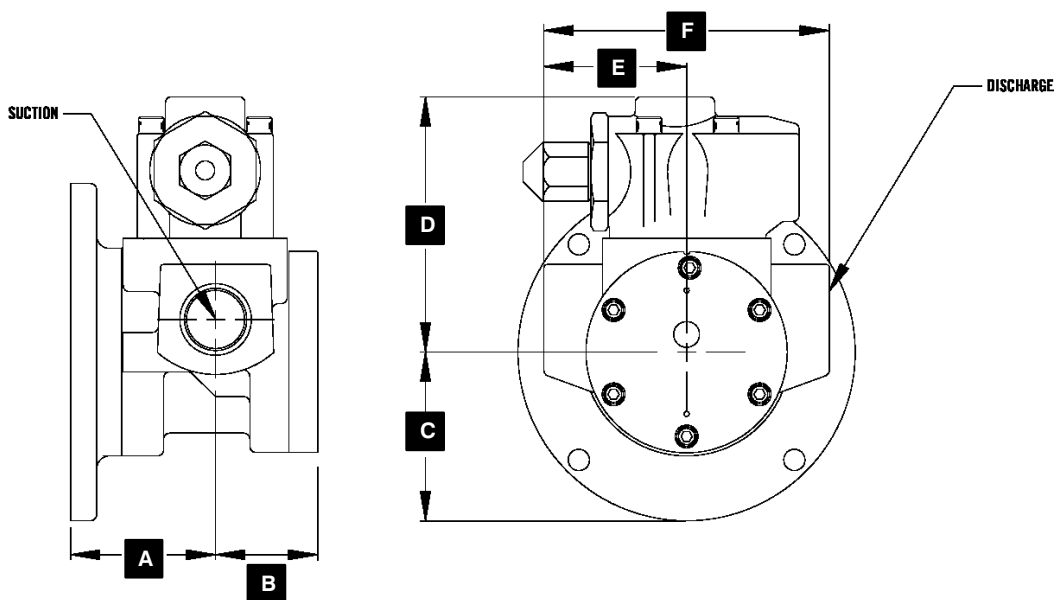

DIMENSIONS								
	A	B	C	D	E	F	Suct.	Disch.
GMC1DE3/40C	2.8 (71,1)	2.7 (68,6)	3.3 (83,8)	5.2 (132,1)	2.5 (63,5)	5.0 (127,0)	1" NPT	1" NPT

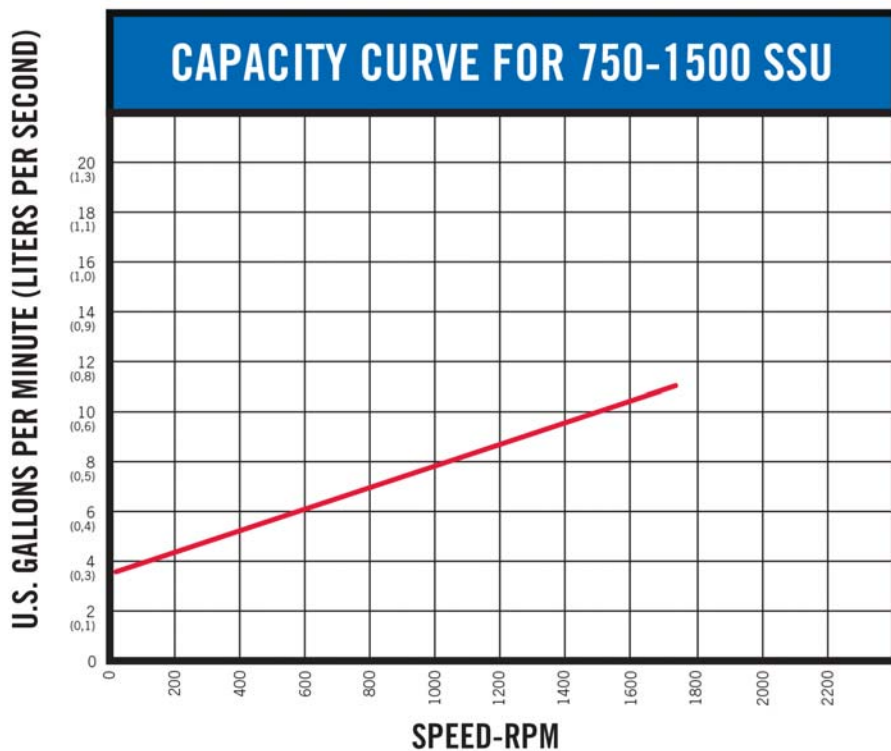

GORMAN-RUPP PUMPS

www.grpumps.com

Specifications Subject to Change Without Notice

Printed in U.S.A.